

ISO 2768-1973	General tolerances							Angles tolerances					
	mm	0.5	3	6	30	120	315	1000	short side length	0	10	50	120
Class		3	6	30	120	315	1000	2000		10	50	120	400
Fine		±0.05	±0.05	±0.1	±0.15	±0.2	±0.3	±0.5	Degree	±1'	±30'	±20'	±10'
Medium		±0.1	±0.1	±0.2	±0.3	±0.5	±0.8	±1.2	mm/100mm	±1.8	±0.9	±0.6	±0.3
Rough		±0.2	±0.5	±0.8	±1.2	±2	±3						

REMOVE ALL BURRS AND SHARP EDGES

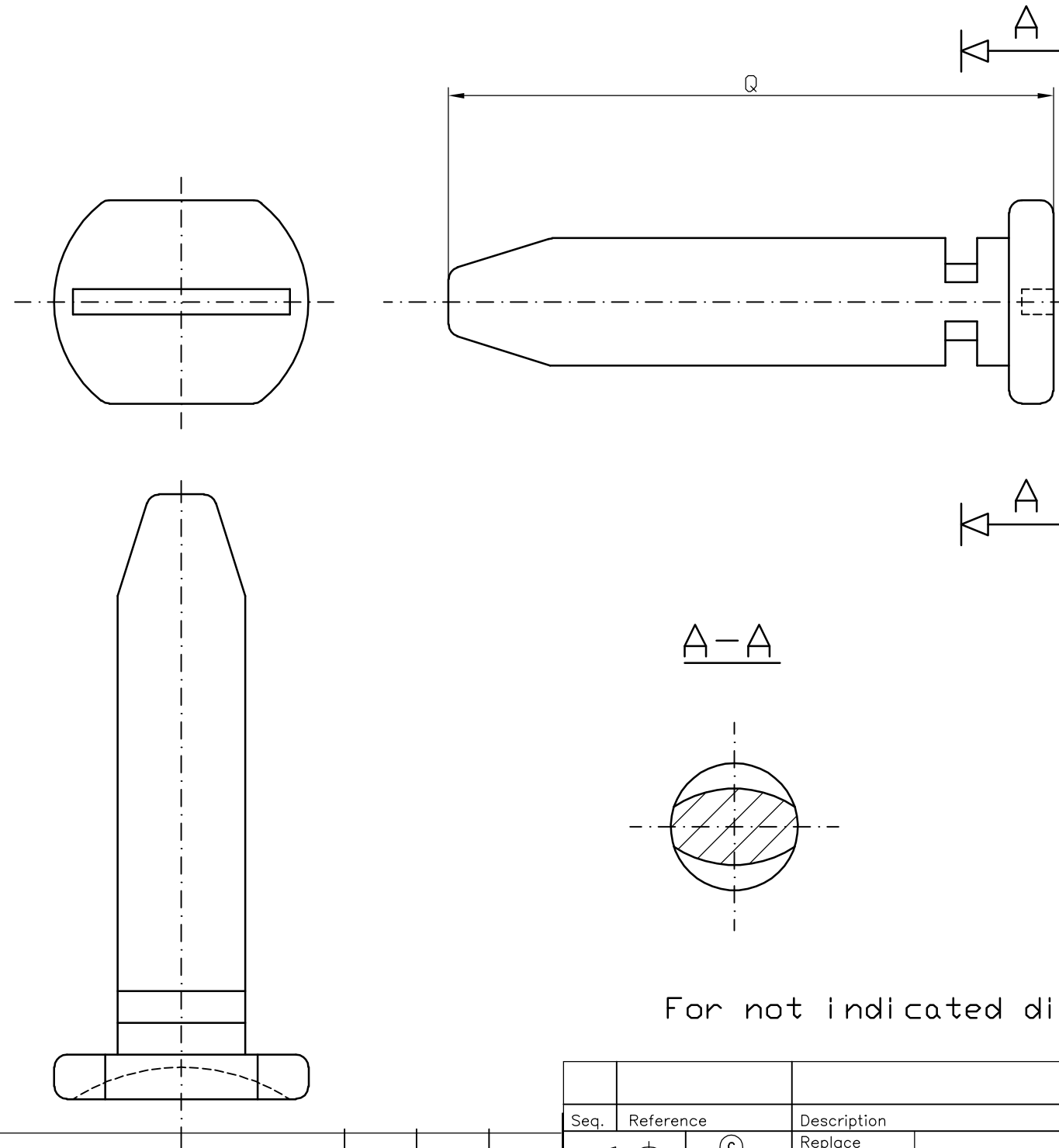

For not indicated dimensions see dwg 61049.

Seq.	Reference	Description	Remark	Unit	Quantity	
		Replace	JB	01.04.25	Scale	
		Replaced by	Checked			
		MATERIAL: ST37.2 ZINC PLATED	Sheet nr	Size		
MOD	DESCRIPTION	DATE	DWN	CHD	DWGNR. 61049-Q	MOD

Copyright by
Power Climber