

## OPERATING MANUAL

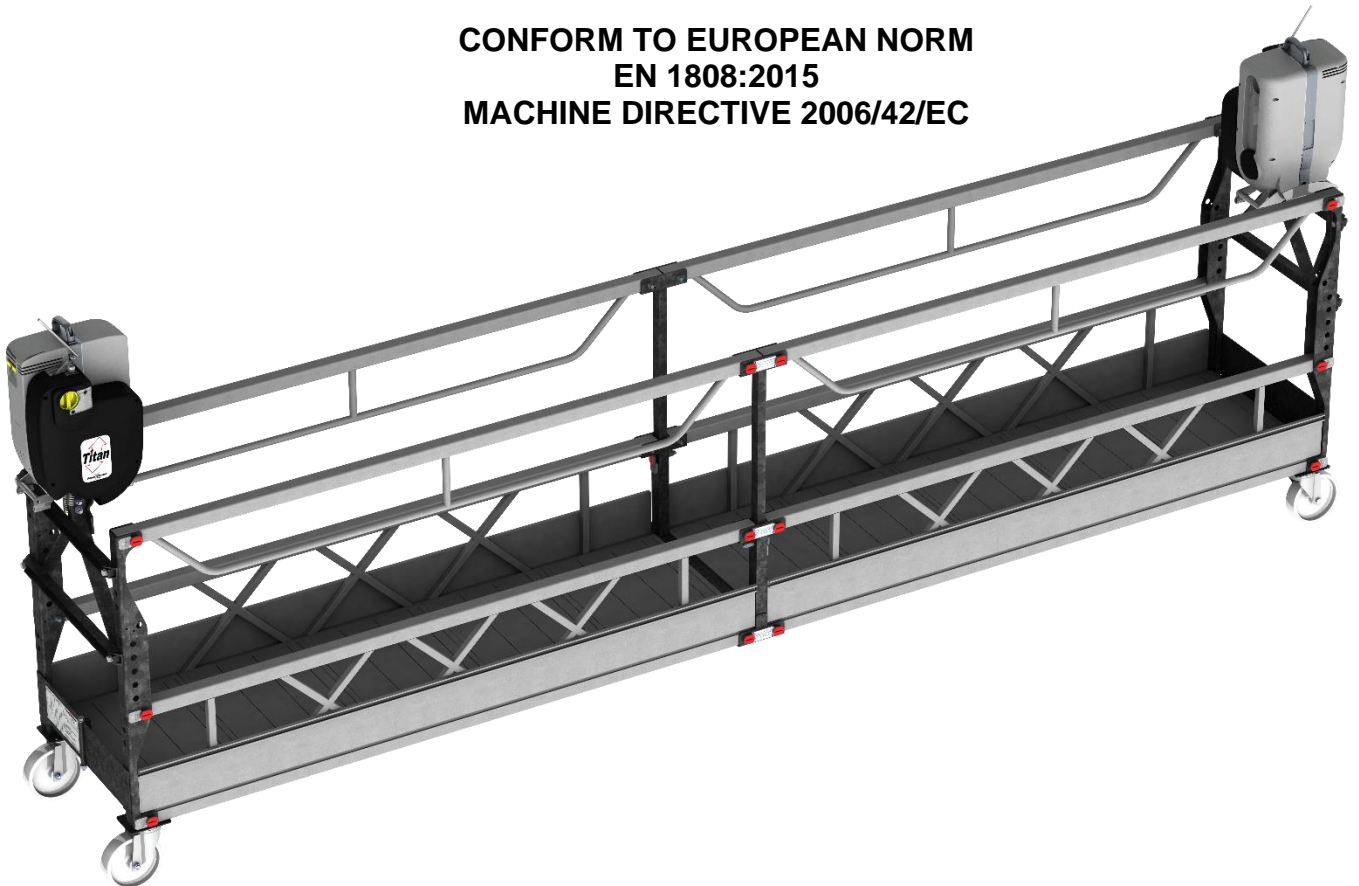

### MODULO<sup>®</sup> 450 MODULO<sup>®</sup> 18''

CONFORM TO EUROPEAN NORM  
EN 1808:2015  
MACHINE DIRECTIVE 2006/42/EC



All persons operating this equipment must read and completely understand this manual.  
Any operation in violation of these instructions is at one's own risk.  
Keep this manual with the equipment at all times.

Only use **POWER CLIMBER** original spare parts and steel wire ropes.

#### Manufacturer

**POWER CLIMBER B.V.B.A.**  
Satenrozen 7  
B- 2550 Kontich  
BELGIUM

Website: [www.PowerClimber.be](http://www.PowerClimber.be)  
Tel: +32-3-451.05.00  
Fax: +32-3-451.05.01  
e-mail: [info@PowerClimber.com](mailto:info@PowerClimber.com)

Reference: 38762-E

Issue date: 2021 DEC 17

Revision: D

Page: 1 of 11



Tel. +32-3-451 05 00

E-mail: [Info@PowerClimber.com](mailto:Info@PowerClimber.com)  
Website: [www.PowerClimber.be](http://www.PowerClimber.be)

Fax +32-3-451 05 01

## Table of Contents

- Table of Contents..... 2
- Description of the platform ..... 2
- General Overview..... 3
  - Exploded view of platform with End Stirrups ..... 3
  - View of platform with Walk Through Stirrups (WTS)..... 3
- Checks before every use..... 4
- Caution..... 5
- Load table platform..... 6
- SafeFix pin system ..... 7
- Mounting..... 8
  - 1) Assembling the U-frames and guard rail posts ..... 8
  - 2) U-frames & Side frames:..... 8
  - 3) Assembling End Frame with Stirrup..... 8
  - 4) Floor ..... 9
  - 5) Guard rail ..... 10
  - 6) Wall Rollers ..... 10
  - 7) Walk through stirrup ..... 10

## Description of the platform

- The modular design of the MODULO® 450 / MODULO® 18” suspended platform allows you to modify the configuration of the standard components to obtain the platform length required.  
All of the components are secured by using the patented SafeFix pin system.
- All components are designed to have a maximum dimension of 450mm (or 18inch), to make it fit through a manhole.

Reference: 38762-E	Issue date: 2021 DEC 17	Revision: D	Page: 2 of 11
--------------------	-------------------------	-------------	---------------



## General Overview

### Exploded view of platform with End Stirrups

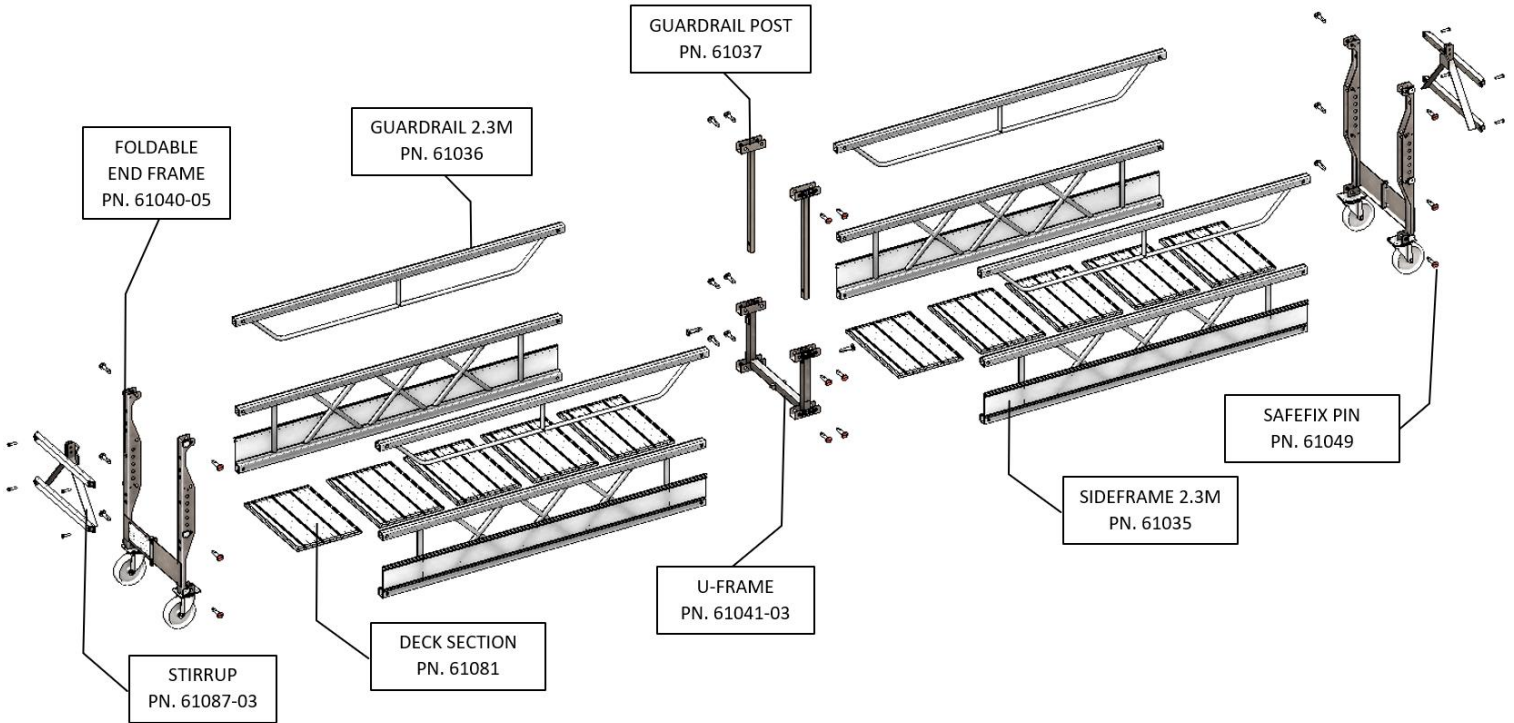

### View of platform with Walk Through Stirrups (WTS)

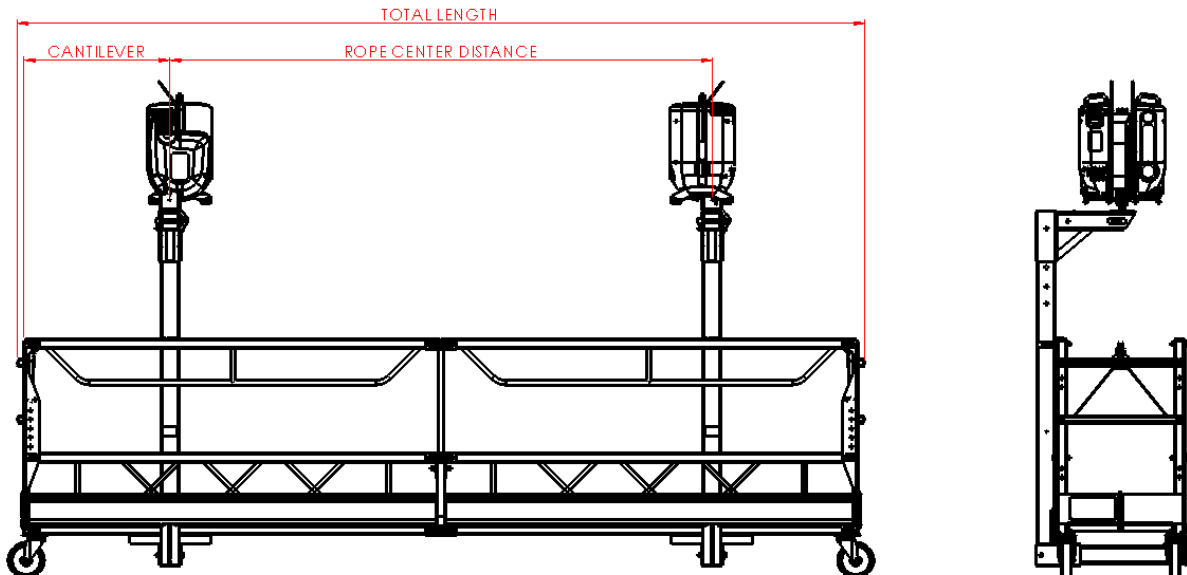

Reference: 38762-E

Issue date: 2021 DEC 17

Revision: D

Page: 3 of 11



Tel. +32-3-451 05 00

E-mail: [Info@PowerClimber.com](mailto:Info@PowerClimber.com)  
Website: [www.PowerClimber.be](http://www.PowerClimber.be)

Fax +32-3-451 05 01

## Checks before every use

1. Check if all of the SafeFix pins are in their locked position:
  - All of the pins' slots have to be in the horizontal position.
  - The only exception to this rule is the pin that attaches a guardrail post: these pins' slots have to be in the vertical position. There are two of these pins per U-frame:

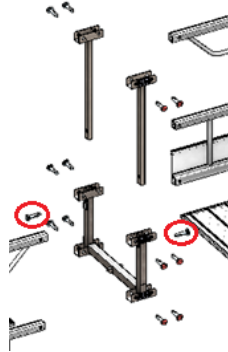

2. Check the condition of the SafeFix pin system:
  - There is pressure in the locked position (the pin wants to stay in this position)
  - General condition of the spring and spring holder
3. Check the condition of all of the holes in the Sideframe, Guardrails, U-frames and Stirrups.
4. Check the condition of the floor retainers: each deck section is being kept down by a spring

Guidelines for use of Titan-hoist: see manual 38742-E.

The cable retainers of the power supply have to be hooked onto the mid rail or cross braces.

The lifeline (personal security) has to be hooked onto the mid rail.

Wind restrictions at 12m/s.

## Caution

1. Before using, check all parts for proper function and damage to component parts. Do not use a damaged or improperly functioning platform.
2. A platform exposed to excessive heat, as in the case of fire, should be immediately removed from service and destroyed due to loss of structural strength.
3. Do not permit oil, grease, or slippery material to accumulate on surfaces.
4. Do not use the product if the decking surface is damaged.
5. The total combined weight of each man and all materials should not exceed the rated working load. Do not overload.
6. Erect the platform so that the working or standing surface is level.
7. Support platform ends by stirrups or walk through stirrups per manufacturer's instructions.
8. Use guard-rails as required, their use is recommended in all cases.
9. Do not allow unstable objects, such as barrels, boxes, loose brick, tools and debris to accumulate on the work surface.
10. Do not use a ladder or other device on a platform to gain greater heights. Never climb onto a stage from a ladder unless the stage and ladder are secured from movement in all directions. Do not apply impact loads to a platform. Never attempt to straighten a deformed side rail or decking member.
11. Do not use acids or other corrosive substances on a plank or platform without consulting the platform manufacturer for specific instructions.
12. Do not use a platform near electrical circuits.
13. Before using, refer to manufacturer's instructions.

## Load table platform

Four different lengths of Modulo 450 platform sections are available:

- **Section A: 0.95m**
- **Section B: 1.40m**
- **Section C: 1.40m**
- **Section D: 2.30m (standard section)**

Different combinations of these sections will result in different platform lengths.

Each combination will have its own load restriction, which also depends on the used hoist. The load table of all possible platform combinations with End stirrups, using the standard 2.3m section (section D) only:

MODULO® 18"/450			Hoist capacity / W.L.L. (kg)											
			500				650				800			
Length - Longueur Gesamtlänge - Lengte	Configuration Aufbau - Configuratie	Self-weight platform only - Poids propre de la plate- forme - Eigengewicht von Bühne	Max. rated load (1)	Max. no. of persons (2)	Max. load per m (3)	Max. WLL per hoist (evenly distributed) (4)	Max. rated load (1)	Max. no. of persons (2)	Max. load per m (3)	Max. WLL per hoist (evenly eistributed) (4)	Max. rated load (1)	Max. no. of persons (2)	Max. load per m (3)	Max. WLL per hoist (evenly eistributed) (4)
(m)		(kg)	(kg)		(kg)	(kg)	(kg)		(kg)	(kg)	(kg)		(kg)	(kg)
2.3	D	100	420	3	186	325	420	3	186	325	420	3	186	325
4.6	D,D	170	700	5	153	500	840	5	186	575	840	5	186	575
6.9	D,D,D	250	620	6	120	500	700	7	120	542	1000	7	146	692
9.2	D,D,D,D	320	550	5	120	500	570	6	120	510	670	7	120	563
11.5	D,D,D,D,D	400	390	3	120	464	390	3	120	464	390	3	120	464

- (1) Max. Rated Load / Charge max. / Max. Nutzlast / Max. toelaatbare belasting  
 (2) Max. no. of persons / No. de personnes max. / Max. Personenzahl / Max. aantal personen  
 (3) Charge max. par mètre / Max. last pro meter / Max. last per meter  
 (4) Max. W.L.L. per hoist / Charge utile max. du treuil / Tragfähigkeit Winde / Werklastlimiet takel

For all of these platforms, the following restrictions apply:

- a platform with end-stirrups should not be configured with more than 4 U-frames.
- a platform with walk-through stirrups should not be configured with more than 4 U-frames between the stirrups and not more than 1 U-frame on each cantilever section.
- a platform with either end-stirrups or walk-through stirrups, can be configured with up to two special sections only, and these can only be placed at each end of the platform.

## SafeFix pin system

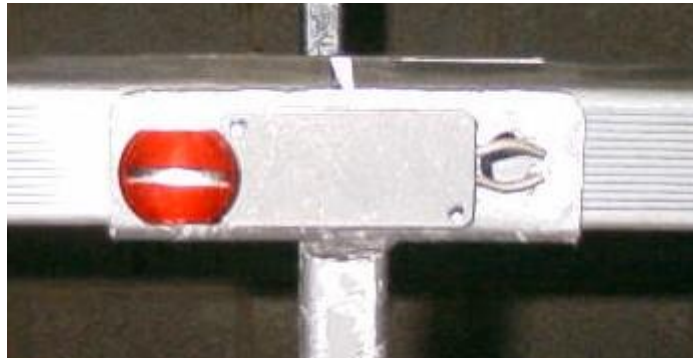

The patented Safe Fix pin system is a one step “insert and snap” method to assemble MODULO® platform components. The slotted pin is fixed in place by a spring mounted on the stirrup or U-frame.

### Insertion:

- Line the pin up with the hole, so that the slot at the base of the pin is horizontal.
- Push the pin in from outside until the spring clicks in the grooves on the shaft of the pin. If required, rotate the pin till the slot is horizontal and the springs are in place.
- Make sure the pin is secured.

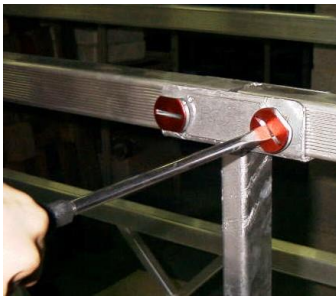

### Removal:

- Rotate the pin ¼ turn till the slot is vertical (and the springs are no longer in the grooves) and pull the pin out.

Note: The pin can be positioned with the use of a hammer and a screwdriver.

**ATTENTION:** Life span of springs: Springs have to be replaced when they no longer exert pressure on the grooves of the pin shaft.

## Mounting

### 1) Assembling the U-frames and guard rail posts

An assembled U-frame exists of:

- U-frame
- 2 pins
- 2 guardrail posts

Slide both guard rail posts into the U-frame and lock with a Safe Fix pin.



Lock with  
Safe Fix  
Pin

### 2) U-frames & Side frames:

Begin assembly by mounting the side frames on the U-frames.  
Secure each side frame to the U-frame with 2 Safe Fix pins.  
Once one U-frame is mounted start with the next U-frame.





### 3) Assembling End Frame with Stirrup

Unfold the end frame  
Secure the stirrup to the end frame (with 4 x M12 bolts).  
Connect end frame to side frames with 4 Safe Fix Pins.

2 bolts M12  
at each side



### 4) Floor

Put in floor (flat side up) as shown.



Check that all 4 retaining springs are in place.



### NOTE:

- To remove floor, push on the spring and lift floor at the same time.
- There is only one size of floor panel. Each section length will need different amount of floor panels
  - **Section A: 2 floor panels**
  - **Section B: 3 floor panels**
  - **Section C: 4 floor panels**
  - **Section D: 5 floor panels**

Reference: 38762-E

Issue date: 2021 DEC 17

Revision: D

Page: 9 of 11

## Mounting (cont.)

### 5) Guard rail

Mount guard rails, inserting 2 Safe Fix pins in each end.



**Remarks:** Never stand on the guardrail or midrail while platform is in use.

### 6) Wall Rollers

Loosen screws to insert the wall rollers in the grooves of the side frame. The wall roller can be located anywhere along the length of the side frame as required. Use minimum 2 wall rollers and put them wide apart.



## 7) Walk through stirrup



- Fit the upper part at desired height and lock with Safe Fix pin.
- Hang the mast over the midrail and screw on the two bolts (do not yet tighten, see below). Make sure that position is in line with the suspension points, otherwise the slack rope safety mechanism will not work properly.
- Fit the lower part into the mast and lock with the second Safe Fix pin.



- Mount the hoist and put the steel wire ropes in the rope guiders.
- When mounting the hoist check the orientation of the hoist.
- Suspend minimum 6 kg on the suspension rope.
- Suspend minimum 12 kg on the safety rope.
- Lift the platform a few centimeters and screw the bolts tighter.